

### Construction Legend

- DENOTES EXISTING WALLS TO BE REMOVED
- DENOTES NEW WOOD FRAME PARTITIONS.
- DENOTES EXISTING WOOD FRAME PARTITIONS.
- DENOTES NEW MASONRY BLOCK CONSTRUCTION, WITH POURED CONCRETE FOOTING
- DENOTES EXISTING MASONRY BLOCK CONSTRUCTION, WITH POURED CONCRETE FOOTING
- DENOTES EXISTING MASONRY BLOCK CONSTRUCTION, WITH 3-1/2" WOOD STUD FURRING AND 1/2" GYPSUM BOARD FINISH (TYPICAL).
- DENOTES EXISTING WOOD STUD CONSTRUCTION, WITH BRICK OR STONE FACE
- DENOTES NEW WOOD FRAME PARTITIONS, WITH R-11 F.G. BATT SOUND PROOFING.

### Door Schedule

- \* NOTE: PROVIDE ALL HARDWARE AS PER CODE.
- (E) DENOTES EXISTING DOOR TO REMAIN
  - (1) DENOTES (2) 3'-0" X 6'-8" HINGED COLONIAL MASONITE DOORS
  - (2) DENOTES (2) 3'-0" X 7'-0" HOLLOW METAL INSULATED ENTRY DOOR TO BE SELECTED BY THE OWNER.

### Floor Finish Legend

- (ETR) DENOTES EXISTING FLOORING TO REMAIN
- (C-1) DENOTES CARPETING WITH PAD TO BE S.B.O.
- (T-1) DENOTES 12"X12" CERAMIC TILE TO BE S.B.O.
- (T-2) DENOTES 8"X8" CERAMIC TILE TO BE S.B.O.
- (M-1) DENOTES 12"X12" MARBLE TILE TO BE S.B.O.
- (W-1) DENOTES EXIST. WOOD FLOOR TO BE SANDED RE-FINISHED AND SEALED
- (W-2) DENOTES NEW T&G MAPLE OR OAK WOOD FLOOR TO BE SELECTED BY THE OWNER (S.B.O.)
- (VCT) DENOTES NEW VINYL COMPOSITION TILE TO BE S.B.O.
- (CM) DENOTES 8" STAIN GRADE CROWN MOLDING
- (CR) DENOTES STAIN GRADE CHAIR RAIL TO BE S.B.O.
- (WNT) DENOTES STAIN GRADE WAINSCOT TO BE S.B.O.
- (CON) DENOTES EXISTING CONCRETE FLOOR TO REMAIN

## Second Floor Construction Plan

SCALE: 1/4" = 1'-0"

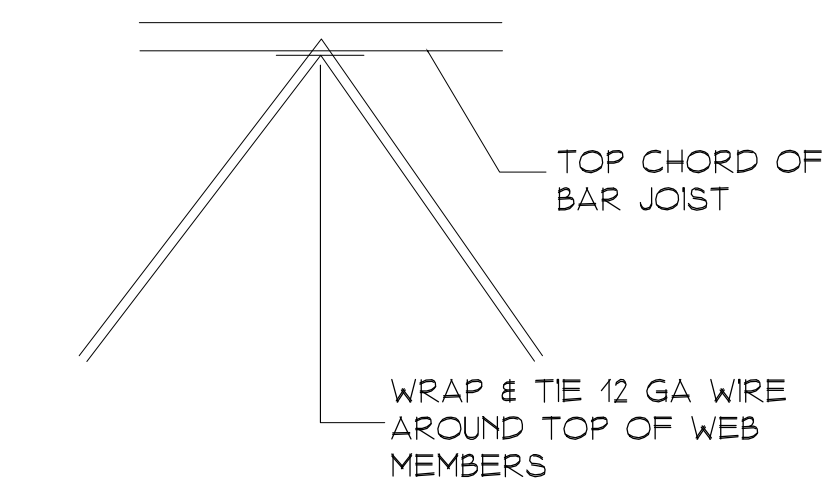

THIS DETAIL TO BE USED TO CONNECT LIGHT FIXTURES AND CEILING GRIDS TO EXISTING STRUCTURE

### Bracing Wire @ Steel Joists

SCALE: NONE

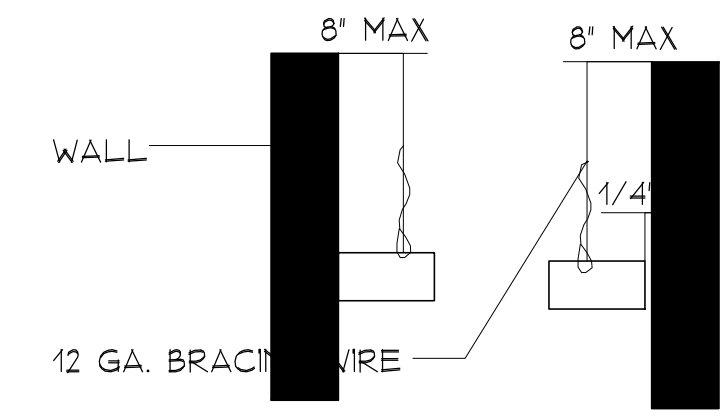

CLEARANCE AT OPPOSITE WALLS (NOT ATTACHED)

### Runners At Walls

SCALE: NONE



## Front Elevation

SCALE: 1/4" = 1'-0"

BRACING NOTE:  
ALL FIXTURES AND CEILING RUNNERS TO BE SECURED TO STRUCTURE ABOVE AS PER CODE. REFER TO DETAILS ABOVE.

### Ceiling Notes:

1. THE SUSPENDED CEILING SYSTEM IS TO BE OF THE TYPE, COLOR AND MANUFACTURER SPECIFIED ON THE DRAWINGS.
2. MAIN RUNNERS ARE TO HAVE A MAXIMUM LENGTH OF 12'-0" AND A LOAD CARRYING CAPACITY OF NOT LESS THAN 12 LBS./LF. HANGER SPACING IS TO BE 4'-0" O.C. HANGER WIRE IS TO BE 1/2 GAUGE.
3. THE INTENT IS TO REUSE THE EXISTING CEILING GRID, CEILING TILE AND LIGHT FIXTURES AS INDICATED. ANY DAMAGED CEILING TILES ARE TO BE REPLACED WITH NEW EXISTING TILES TO MATCH.

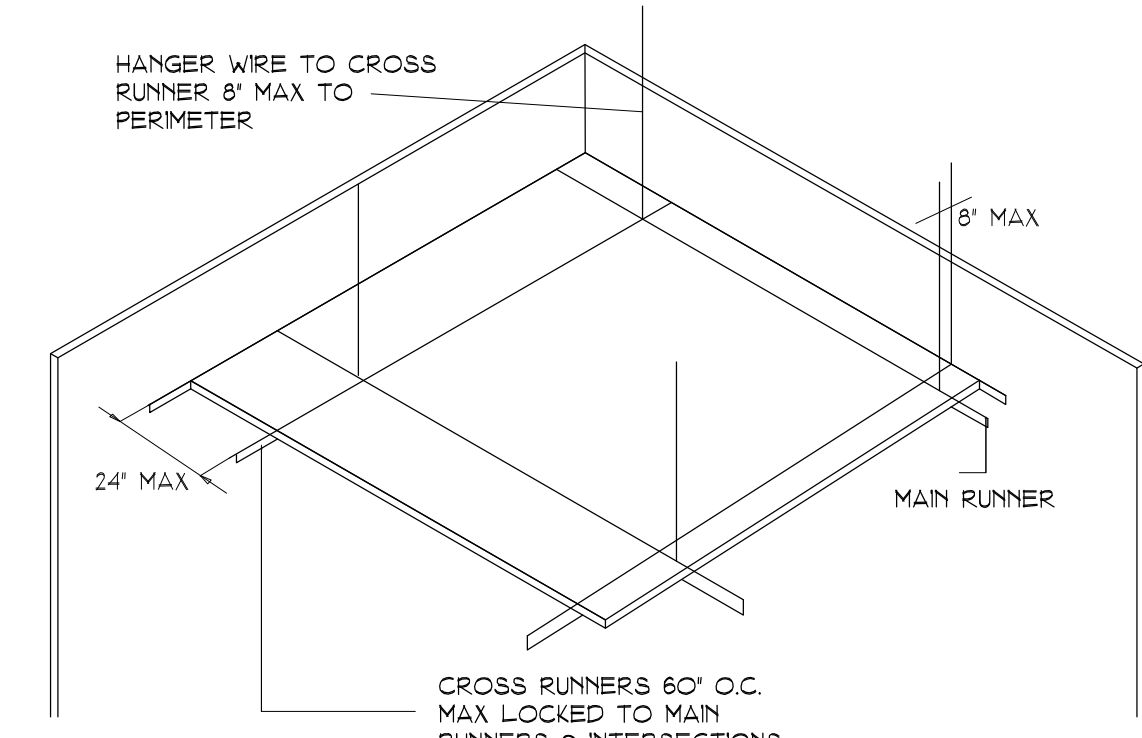

### Suspended Ceiling w/Locking Cross Runners

SCALE: NONE

**General Notes:**

THIS DESIGN IS PROTECTED BY A COPYRIGHT. ANY USE OR REPRODUCTION OF THIS MATERIAL MUST BE WITH THE EXPRESSED WRITTEN CONSENT OF GSM ARCHITECTS LLC.

**Engineer**

**Contractor**

**Key Plan:**

Drawing Revisions		
No.	Date	Description
1	12/01/2019	Issued For Permit
2	05/04/2020	Issued For BOA Review

**Architect:**

**SCOTT MONRO ARCHITECT**  
170 Kinnelon Road, Suite 21  
Kinnelon, New Jersey 07405  
(973) 283-0931  
Email: smonro@gsmarchitects.com

(NJ) License #13715

**Project Name & Address:**

Del Balso  
421 S RT 23  
Pomptain Plains, New Jersey 07444  
Block 57 - Lot 68.28

<b>Project Number:</b> 18-019	<b>Sheet Number:</b> A-3
<b>Date:</b> December 1, 2019	Sheet 3 of 4
<b>Drawn By:</b> gsm	
<b>Scale:</b> As Noted	